

# TINA 928A-L3126B-04 Surface Mounted Spotlight TINA IP65 LED SMD 26W 3300lm CRI90 3000K 8° 90° Anthracite

La familia Tina consiste en proyectores de superficie montados sobre la pared y proyectores de poste, está fabricada de aluminio y cuenta con IP65. Está disponible en varias temperaturas de color y diferentes tamaños, su durabilidad es de 50000 horas. Gracias a su versatilidad es ideal para instalaciones en espacios exteriores.

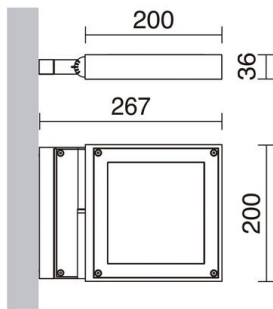

## GENERAL DATA

Category	Spotlights
Family	Tina
Finish	[04] Anthracite
Location	Outdoor
Installation	Wall
Body material	Aluminum
Diffuser material	Transparent glass
ETIM class	EC001744
EAN	8433264105006

## LIGHT SOURCES AND BEAMS

Sources	LED SMD 26W max. 3300lm 3000K CRI90
Total flux	2830 lm
Energy efficiency	F
Beam	8° - Directa

## TECHNICAL DATA

Dimensions	Width x Height x Depth (mm): 200 x 36 x 267
IP	IP65
Protection class	Class I
Frequency	50/60 Hz
Input voltage	220-240V AC V
Output current	490 mA
Power factor	0.95
Auxiliary gear	Electronic
Auxiliary equipment brand	TCI
Lifetime	50.000 h
LED lifetime L	80
LED lifetime B	20
Cable outlets	1
Tilt angle	90.0 °
Rotation angle	350.0 °
ECORAAE category I	LED-C

**TINA** 928A-L3126B-04 Surface Mounted Spotlight TINA IP65 LED SMD 26W 3300lm CRI90 3000K 8°  
90° Anthracite

PRODUCTS OF THE SAME FAMILY

---



Tina B