

Suppose the external flexible cable or cord of this luminaire is damaged. In that case, it shall be exclusively replaced by the manufacturer, his service agent, or a similarly qualified person to avoid a hazard.

The light source of this luminaire is not replaceable; when the light source receives its end of life the whole luminaire shall be replaced.

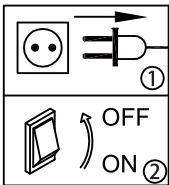

1. Remove the two screws (one upper and one lower)

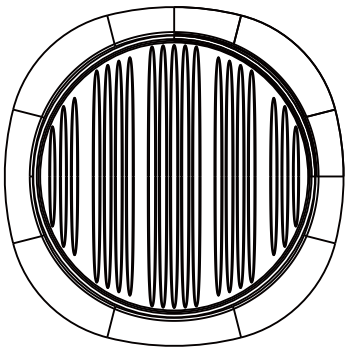
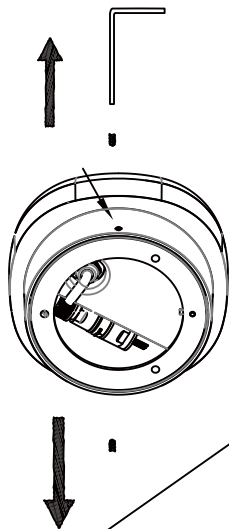

Open

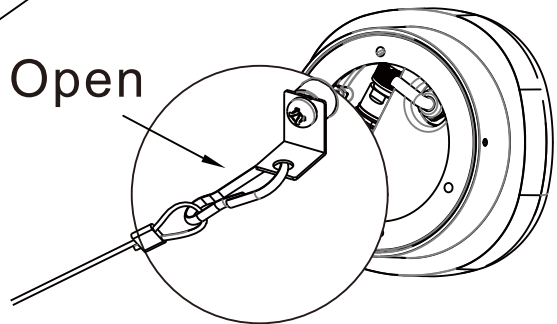

2. Tighten the backplate with mounting screws

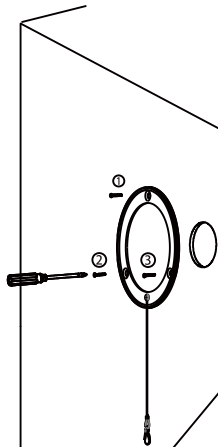

Buckle in

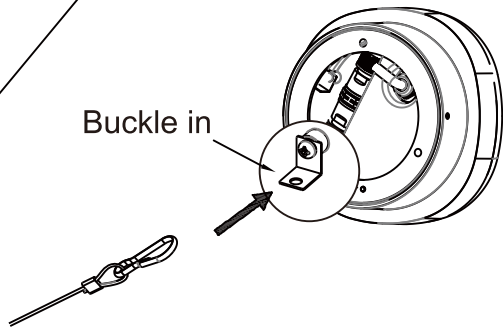

3. Connect wire and mount the screws

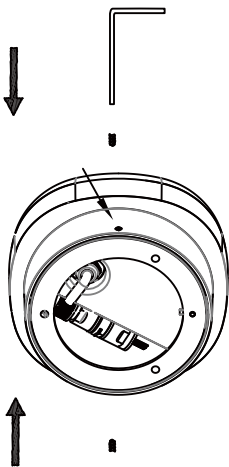
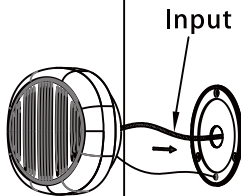

4. Installation complete

