

# Dea Eros-Q2 XS TR

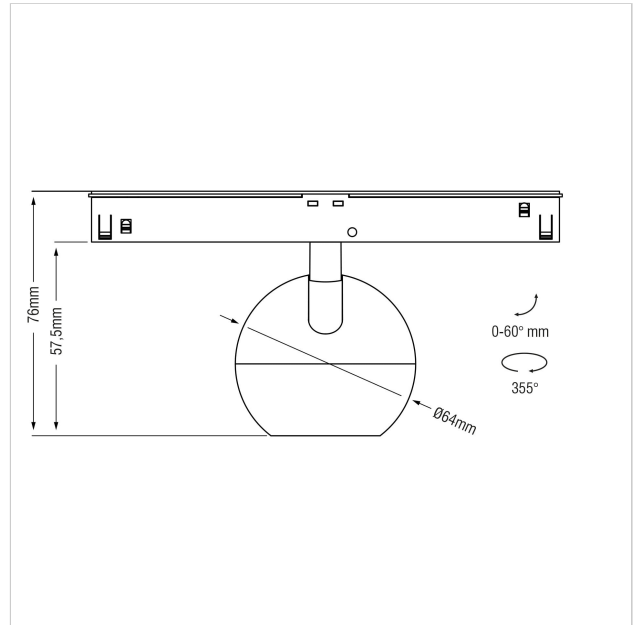
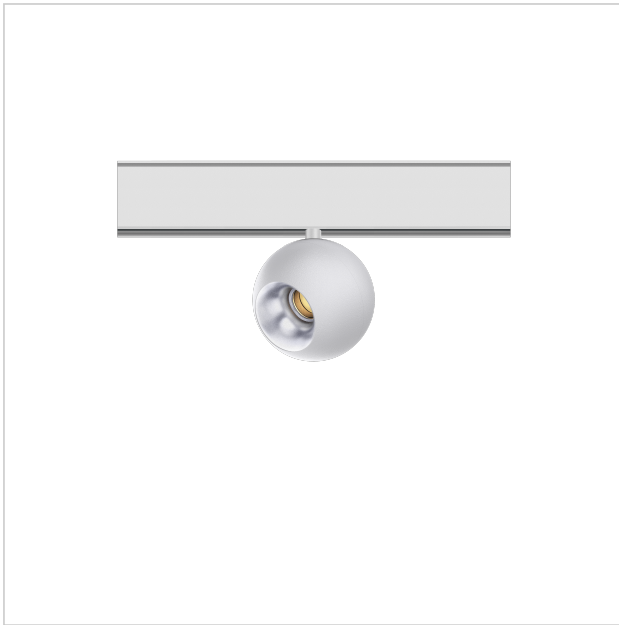

|                           |                         |
|---------------------------|-------------------------|
| SKU                       | : Q665BW92734SGF0       |
| Housing material          | : Aluminum Die Cast     |
| Luminaire Color           | : White                 |
| Optic                     | : Reflector             |
| Reflector Color           | : Silver High Gloss     |
| Power supply              | : Included ON/OFF       |
| Luminous Flux (lm)        | : 490lm                 |
| System power              | : 7W                    |
| System efficiency         | : 70lm/W                |
| Beam angle (°)            | : 34°                   |
| CCT (K)                   | : 2700K                 |
| CRI                       | : 90                    |
| Chromaticity tolerance    | : 3 MacAdam             |
| Mains Voltage             | : 220-240V / 50 -60Hz   |
| EI. Class                 | : Class III             |
| Lifetime                  | : 50000h                |
| IP rating                 | : IP20                  |
| Light source energy class | : F                     |
| Light source identifier   | : CLU701-1002C4-273H5K2 |
| Net. Weight               | : 0.2Kg                 |
| Warranty                  | : 5Y                    |

All rated values @ ambient temperature of 25° C. Electric and photometric values are initially subject to a tolerance of +/- 10%. Tolerance of color temperature +/- 150K. Technical data can change without prior notice.

©2022 Karizma Luce BV. All rights reserved. Please visit [karizmaluce.com](http://karizmaluce.com) for more information.